

Crawl Space Insulation

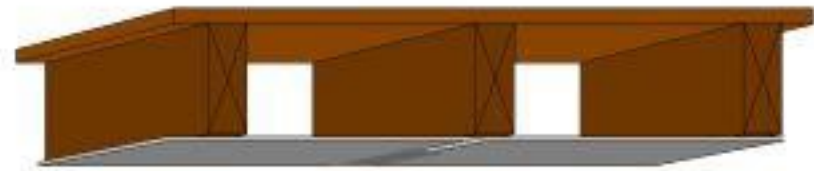

TOOLS YOU WILL NEED



SCISSORS OR RAZOR KNIFE

TAPE MEASURE



STAPLER

INSTALLATION TIPS

Tape any tears in the material

For RBI Shield™ to perform as a continuous vapor barrier, all seams, openings, and pipes should be taped.

Use a Foil Tape that does not have a backing layer. This just makes it easier on the installer. Fi-Foil's RS Tape is a reinforce tape with no backing layer.

Beware of any hazards that may exist in the crawl space such as exposed electrical wiring, nails, or other dangerous objects.

Caution: Aluminum is conductive to electricity. Use extra care around all wiring and junction boxes.

1. Run the RBI Shield™ product with the floor joists (parallel not perpendicular). To seam the product, you need a rigid surface under the seam. This will assist in a long-term seal of the seam.

2. If you are using RBI Shield™ Tape Tab version, you do not need to tape each seam. Otherwise tape all seams and seal all penetrations.

3. Use tape, spray foam or mastic around large penetrations like piping, strapping, and HVAC ducts. One of the benefits of the RBI Shield™ is that it will reduce air infiltration. Details around the penetrations will improve performance.

4. After lapping the product down on the wall, a final detail is to seal around the entire perimeter wall and piers by running a bead of caulk, mastic, or spray foam under this tab.

