

## Acrovyn .040N Sheet

### Product Data

.040" thick Acrovyn high-impact wall covering can be installed over a variety of substrates at full or partial height.

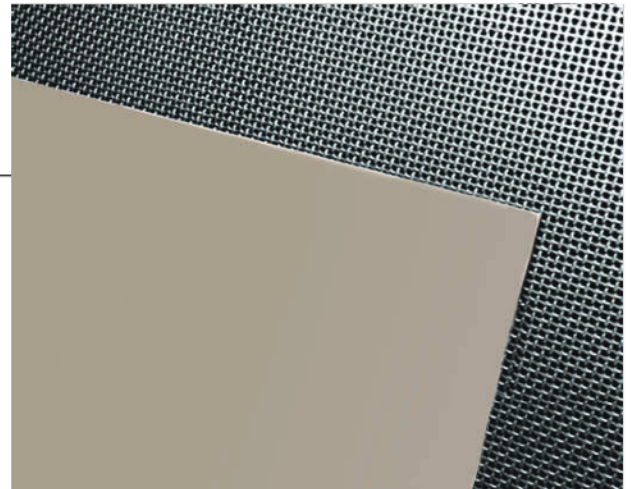

Solid Colors | Chameleon Patterns

### Technical Data:

- .040" (1.02mm) thick Acrovyn sheet
- Standard sheet sizes for solid colors are 4' x 8' (1.2m x 2.4m) and 4' x 10' (1.2m x 3.0m)
- Standard sheet size for Chameleon™ patterns is 4' x 10' (1.2m x 3.0m); pattern direction runs parallel to 10' (3.0m) side of sheet
- Adhesive mount

### Features:

- UL Class A/1 fire rated and labeled
- Suede texture Acrovyn
- Engineered PETG free of PVC and PBTs
- CA 01350 protocol for low VOC
- 5 year product warranty
- Chameleon limited lifetime warranty

### Options:

- Maximum 12' (3.7m) length; for larger sizes please contact factory
- Radius, custom forming and cut to size available
- Color-matched or clear caulk
- Acrovyn wainscot, vertical, inside and outside trim supplied in 10' (3.1m) lengths (solid colors only)
- Aluminum wainscot, vertical, inside and outside trim supplied in 12' (3.7mm) lengths - 135 degree available
- Specified factory-thermoformed inside and outside corners (adhesive mount) - models TFC and TFCH
- Additional textures available: sizes 43" x 90" (1.1m x 2.3m) and 43" x 114" (1.1m x 2.9m)
- Primer or no primer

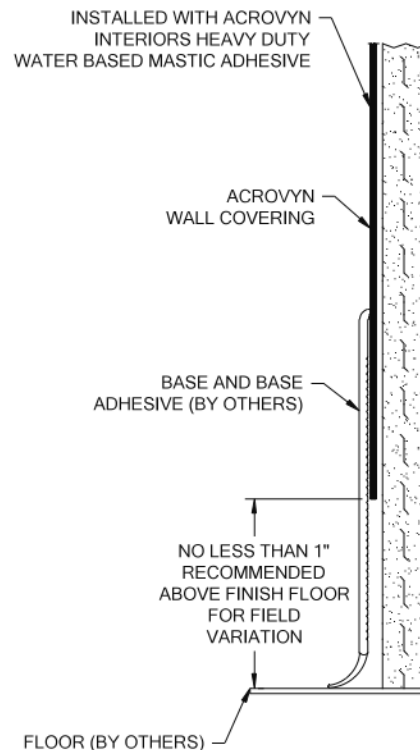

### Similar Models:

- Acrovyn .060N and .075" sheet
- Acrovyn by Design® sheet
- Saratoga® Wall System
- Stainless Steel sheet



**SUGGESTED SPECIFICATIONS**  
**SECTION 10 26 00**  
**CS Acrovyn 4000 .040N Sheet**

**Part 1 - General**

**1.01 Summary**

**A.** This section includes the following types of wall protection systems:

**1.** Wall Covering

**B.** Related sections: The following sections contain requirements related to this section:

- 1.** Handrails, Corner Guards, Bumper Guards, Crash Rails, Accent Rails, Wall Panels, Door Protection; refer to section 10 26 00 "Wall and Door Protection"

**1.02 References**

- A.** National codes (IBC, UBC, SBCCI, BOCA and Life Safety)  
**B.** American Society for Testing and Materials (ASTM)  
**C.** Underwriters Laboratories (UL)  
**D.** California 01350 specification

**1.03 Submittals**

General: Submit the following in accordance with conditions of contract and Division 1 specification section 01 33 00 "Submittal Procedures":

- A.** Product data and detailed specifications for each system component and installation accessory required, including installation methods for each type of substrate.  
**B.** Shop drawings showing locations, extent and installation details of wall covering products.  
**C.** Samples for verification purposes: Submit the following samples, as proposed for this work, for verification of color, texture, pattern and thickness:  
**1.** Sample of each product specified.  
**D.** Product test reports from a qualified independent testing laboratory showing compliance of each component with requirements indicated.  
**E.** Maintenance data for wall protection system components for inclusion in the operating and maintenance manuals specified in Division 1.

**1.04 Quality Assurance**

- A.** Installer qualifications: Engage an installer who has no less than 3 years experience in installation of systems similar in complexity to those required for this project.  
**B.** Manufacturer's qualifications: Not less than 5 years experience in the production of specified products and a record of successful in-service performance.  
**C.** Code compliance: Assemblies should conform to all applicable codes including IBC, UBC, SBCCI, BOCA, Life Safety and CA 01350.  
**D.** Fire performance characteristics: Provide engineered PETG wall protection system components with UL label indicating that they are identical to those tested in accordance with ASTM E84 for Class A/1 characteristics listed below:  
**1.** Flame spread: 25 or less  
**2.** Smoke developed: 450 or less  
**E.** Impact strength: Provide wall protection components that have been tested in accordance with the applicable provisions of ASTM F476.  
**F.** Chemical and stain resistance: Provide wall protection system components with chemical and stain resistance in accordance with ASTM D543.

**G.** Color match: Provide wall protection components that are color matched in accordance with the following:

- 1.** Delta Ecmc of no greater than 1.0 using CIE Lab color space. (Specifier note: Construction Specialties' colors are matched under cool white fluorescent lighting and computer controlled within manufacturing tolerances. Color may vary if alternate lighting sources are present.)

**H.** Single source responsibility: Provide all components of the wall protection system manufactured by the same company to ensure compatibility of color, texture and physical properties.

**1.05 Delivery, Storage and Handling**

- A.** Deliver materials to the project site in unopened original factory packaging clearly labeled to show manufacturer.  
**B.** Store materials in undamaged packaging in a clean, dry place out of direct sunlight and exposure to the elements. A minimum room temperature of 40°F (4°C) and a maximum of 100°F (38°C) should be maintained.  
**C.** Materials must be stored flat.

**1.06 Project Conditions**

- A.** Materials must be acclimated in an environment of 65-75°F (18-24°C) for at least 24 hours prior to beginning the installation.  
**B.** Installation areas must be enclosed and weatherproofed before installation commences.

**Part 2 - Products**

**2.01 Manufacturers**

**A.** Interior surface protection products specified herein and included on the submittal drawings shall be manufactured by Construction Specialties, Inc.

**2.02 Materials**

- A.** Engineered PETG: Rigid sheet should be high-impact Acrovyn 4000 with standard Suede texture, nominal .040" (1.02mm) thickness. Chemical and stain resistance should be per ASTM D543 standards as established by the manufacturer. Colors to be indicated in the finish schedule from one of manufacturer's available colors and patterns.  
**B.** Aluminum: Optional aluminum trims to be alloy 6063 T5 with clear or colored anodized finish; minimum strength and durability properties as specified in ASTM B221. The colored anodized finish is available in eight colors and is not covered under 1.04.G.

**2.03 Wall Covering**

**A. Engineered PETG rigid sheet to be CS Acrovyn: Nominal .040" (1.02mm) thick rigid sheet supplied in 4' x 8' or 10' (1.2m x 2.4m or 3.0m) sheet sizes in standard Suede texture. Optional textures shall be 43" x 90" or 114" (1.1m x 2.3m or 2.9m). Select from one of Acrovyn solid colors or Chameleon™ simulated patterns. Standard Chameleon sheet size is 4' x 10' (1.2m x 3.0m); pattern direction runs parallel to 10' (3.0m) side of sheet. Specify color matched caulk, clear caulk, Acrovyn trims or aluminum trims as needed for joints/transitions.**  
 [Specifier note: refer to the Acrovyn Cradle to Cradle Product Summary at [www.acrovyn.com/c2c](http://www.acrovyn.com/c2c) to determine which colors and patterns are Cradle to Cradle Certified™ Gold or Silver (exceptions: adhesive, primer and caulk). Cradle to Cradle Certified™ is a certification mark licensed by the Cradle to Cradle Products Innovation Institute.]

**2.04 Fabrication**

**A.** General: Fabricate wall covering to comply with requirements indicated for design, dimensions, detail, finish and sizes.

**2.05 Finishes**

**A.** General: Comply with NAAMM "Metal Finishes Manual" for recommendations relative to applications and designations of finishes.

**2.06 Accessories**

- A.** Adhesive: Acrovyn wall covering shall be furnished as a complete packaged system, including appropriate standard adhesive.  
**B.** Primer, caulk and trims available for purchase.

**Part 3 - Execution**

**3.01 Examination**

- A.** Verification of conditions: Examine areas and conditions under which work is to be performed and identify conditions detrimental to proper or timely completion.  
**1.** Do not proceed until unsatisfactory conditions have been corrected.

**3.02 Preparation**

- A.** Surface preparation: Prior to installation, clean substrate to remove dirt, debris and loose particles. Perform additional preparation procedures as required by manufacturer's instructions.  
**B.** Protection: Take all necessary steps to prevent damage to material during installation as required in manufacturer's installation instructions.

**3.03 Installation**

- A.** Install the work of this section in strict accordance with the manufacturer's recommendations using approved adhesive.  
**B.** Temperature at the time of installation must be between 65-75°F (18-24°C) and be maintained for at least 48 hours after the installation to allow for proper adhesive set-up.  
**C.** Relative humidity shall not exceed 80%.  
**D.** Do not expose wall covering to direct sunlight during or after installation. This will cause the surface temperature to rise, which in turn will cause bubbles and delamination.

**3.04 Cleaning**

- A.** General: Immediately upon completion of installation, clean material in accordance with manufacturer's recommended cleaning method.  
**B.** Remove surplus materials, rubbish and debris resulting from installation as work progresses and upon completion of work.

**3.05 Protection**

**A.** Protect installed materials to prevent damage by other trades. Use materials that may be easily removed without leaving residue or permanent stains