

105 Series Surface Mount

A01 - Floor to Floor

A02 - Floor to Wall

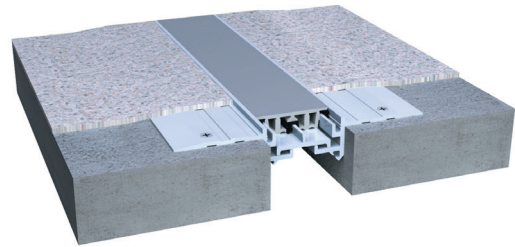

Movement Rating $\pm 25\%$

Product Guide



Thermal



Interior



Fire Rated
Option



Vapor Barrier
Option



ADA
Compliant

- ▶ System is ideal for both new and retrofit construction
- ▶ Frames designed to allow for smooth transition over joint system when used with vinyl flooring
- ▶ Seamlessly integrates with the following wall and ceiling systems: 101,104,112,113,118 A07/A09
- ▶ Easy to clean flush seals, no dirt or water traps
- ▶ Standard and Custom seal colors available.
 - All seals achieve UL Environmental Greenguard Gold Certification for ultra low VOC's
- ▶ Dual durometer seal provides a secure fit and optimal flexibility
- ▶ Standard loading capabilities

Application	System	W		H1		H2		S		B		Movement +/-			
		Joint Width		Frame Height 1		Height 2		Sightline		Blockout		Horizontal		Vertical	
		US	mm	US	mm	US	mm	US	mm	US	mm	US	mm	US	mm
Floor to Floor	105-A01-025	1"	25	5/8"	16	1/8"	3	1"	25	*	*	1/4"	6	1/4"	6
	105-A01-038	1 1/2"	38	5/8"	16	1/8"	3	1 1/2"	36	*	*	3/8"	10	3/8"	10
	105-A01-050	2"	51	1"	25	1/8"	3	2"	47	*	*	1/2"	13	1/2"	13
Floor to Wall	105-A02-025	1"	25	5/8"	16	1/8"	3	1"	25	*	*	1/4"	6	1/4"	6
	105-A02-038	1 1/2"	38	5/8"	16	1/8"	3	1 1/2"	36	*	*	3/8"	10	3/8"	10
	105-A02-050	2"	51	1"	25	1/8"	3	2"	47	*	*	1/2"	13	1/2"	13

IPC.638/REV.9

105 Series

Surface Mount Floor Systems

105-A01 Floor/Floor

(1 1/2" (38mm) system shown)

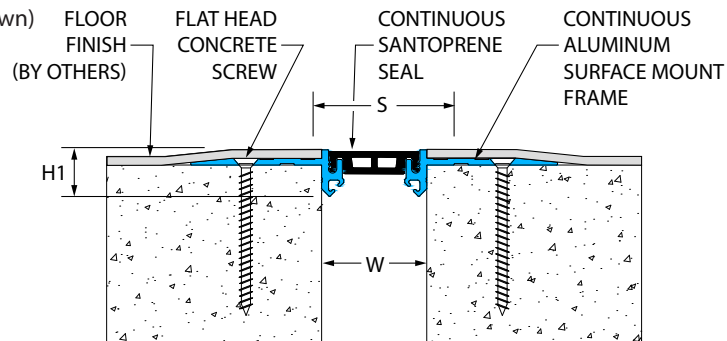

105-A02 Floor/Wall

(2" (50mm) system shown)

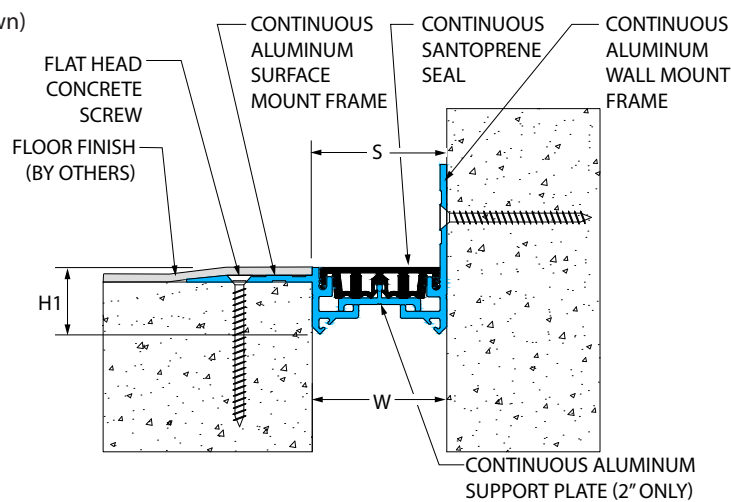

105 Series options

Integral Vapor Barrier

(105-A01-038 system shown)

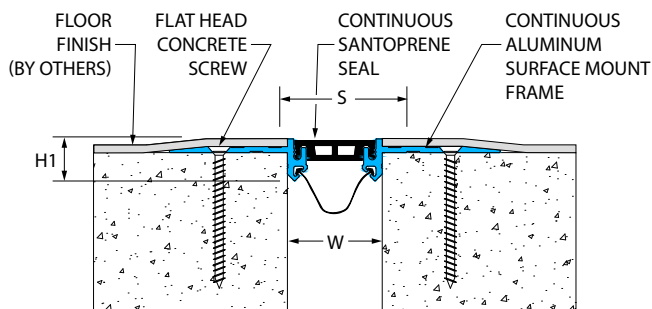

Mineral Wool and Self Leveling Sealant

(105-A01-050 system shown)

